

xx 2 Anti-Seep Collar(s) Shall be Installed.  
 (It) (They) Shall be Located at (Centerline)  
 (12' From Centerline) of Dam and Spaced at  
 a Distance of 20'-0" Apart.

Locate Principal Spillway Pipe  
 at  $\nabla$  Dam @ Sta. 5 + 00 at  
 an Angle of 15 degrees.

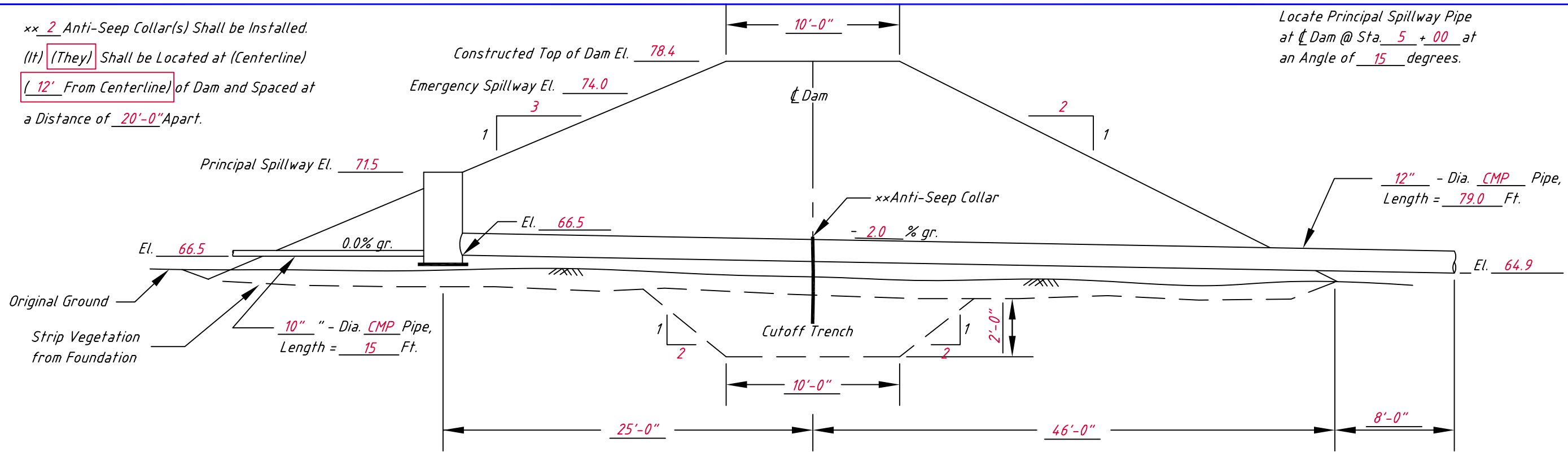

**CROSS SECTION OF DAM ALONG  $\nabla$  OF PRINCIPAL SPILLWAY**

(Not To Scale)

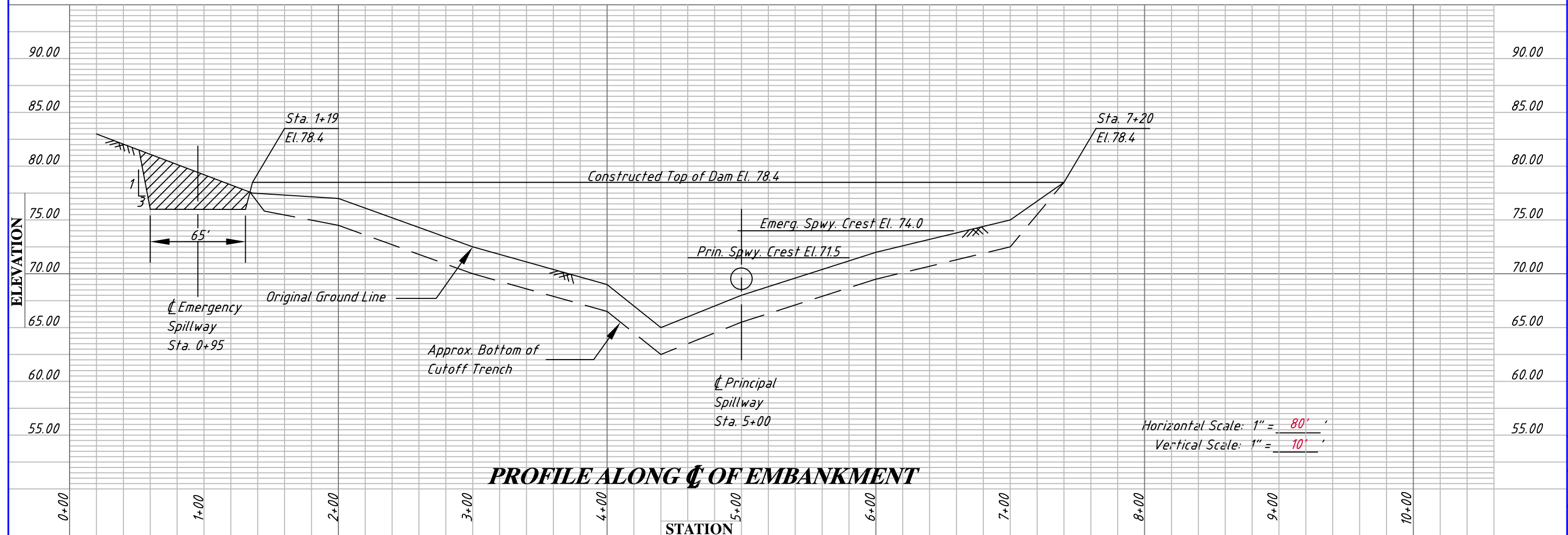

**PROFILE ALONG  $\nabla$  OF EMBANKMENT**

Horizontal Scale: 1" = 80' '  
 Vertical Scale: 1" = 10' '

Date: 1/00  
 Designed: John Doe  
 Drawn: John Doe  
 Checked: \_\_\_\_\_  
 Approved: \_\_\_\_\_

John Doe Wetland  
 Embankment Profile and Cross Section

Natrona County Conservation District  
 Natrona County, Wyoming

USDA NRCS  
 Natural Resources Conservation Service

File No.  
 378-08aexample.dwg

Drawing No.  
 WYWET202'00

Sheet 2 of 3